

GROUND FLOOR
860 sq.ft. (79.9 sq.m.) approx.

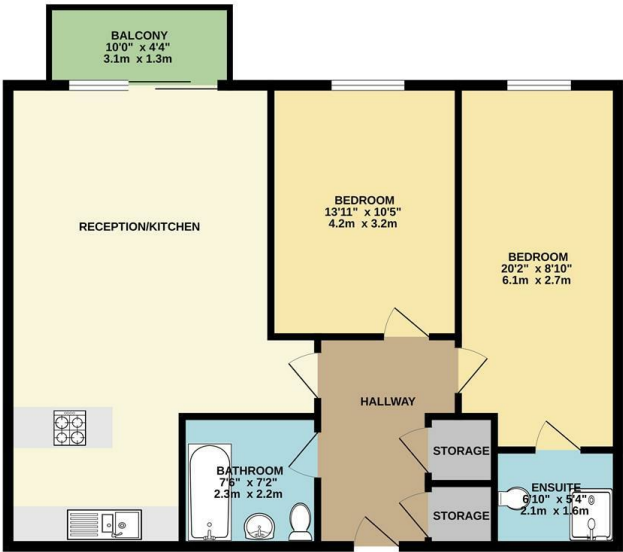

TOTAL FLOOR AREA: 860 sq.ft. (79.9 sq.m.) approx.
While every effort has been made to ensure the accuracy of the figures contained herein, measurements of areas, volumes, etc. are not guaranteed and no responsibility is taken for any error, omission or misstatement. This plan is for illustrative purposes only and should not be used for any other purpose without the prior written consent of the agent.

Council: Redbridge | Council Tax Band: D | Floor Area: sq ft

Energy Efficiency Rating		
	Current	Potential
Very energy efficient - lower running costs		
(92 plus) A		
(81-91) B		
(69-80) C		
(55-68) D		
(39-54) E		
(21-38) F		
(1-20) G		
Not energy efficient - higher running costs		
England & Wales	EU Directive 2002/91/EC	



The Agent has not tested any apparatus ,equipment, fixtures and fittings or services and so cannot verify that they are in working order or fit for the purpose. A buyer is advised to obtain verification from their solicitor or surveyor.
References to the tenure of a property are based on information supplied by the seller. The agent has not had the sight of the title documents. A buyer is advised to obtain verification from their solicitors.

CHURCHILL
estates



CHURCHILL
estates

Kingswood Heights, South Woodford, E18 2FP

£2,100 Per Month

Bedrooms: 2 | Reception Rooms: 1 | Bathrooms: 2



Request a Viewing: **0208 530 3333** Email: **southwoodford@wearechurchills.co.uk**



Available from March And UNFURNISHED- Churchill Estates are pleased to offer this spacious two double bedroom purpose built apartment set within this much sought after and gated contemporary development with 24 hour concierge and well tendered gardens. This Property benefits from a en suite to master, family bathroom, spacious open/plan lounge/modern fitted kitchen and decked private balcony. Further features include underground allocated parking space and entry phone security system, double glazing, gas central heating and within a close proximity to South Woodford Central line station bars and local shops. Early viewings advised

